

# 3045 FC

Issued Sept. 2002 • Index No. M/6.6

Wire Feeder 

## Quick Specs

### Light Industrial Applications

Light Construction  
Maintenance and Repair  
Farm

### Processes

Flux Cored (FCAW)  
MIG (GMAW) (optional)

**Control Input Power** 115 VAC

**Wire Spool Capacity** 2 lb (0.9 kg), 4 in (102 mm)  
10 lb (4.5 kg), 8 in (203 mm)

**Wire Feed Speed** CC: 30–350 IPM (.8–8.9 MPM)  
CV: 30–600 IPM (.8–15.3 MPM)  
(Actual range is dependent on arc voltage applied.)

**Weight** **Wire Feeder:** 29 lb (13.2 kg)  
**Gun:** 5.4 lb (2.6 kg)

## The Power of Blue.®

**New!**

**Ability to do** self-shielding Flux Cored wire welding with a constant-current or constant-voltage, engine-driven, or static DC welder on 16 gauge–3/8 in steel.

Add the **optional gas solenoid kit** to use with a DC Stick welder when welding with flux cored wire requiring shielding gas.

With the **optional gas solenoid kit**, the unit can also be used with constant-voltage (CV) power sources as a **lightweight portable feeder** for welding with solid wire or flux cored wire.

**Standard built-in contactor** makes the wire electrically “cold” until the trigger is pulled, making the unit safer and easier to position torch to work before starting weld.

The spool hub accepts **standard 8 in (203 mm) spools**. Remove the hub and the shaft accepts **smaller 4 in (102 mm) spools**.



### Comes Complete With:

- Wire feeder
- 10 ft (3 m), 250 A gun with cable assembly and liner for .030–.035 in (0.8–0.9 mm) wire
- Two contact tips for .030 in (0.8 mm) wire and two tips for .035 in (0.9 mm) wire
- A quick-change dual groove V-knurled drive roll for .030–.035 in (0.8–0.9 mm) or .045 in (1.2 mm) flux cored wire
- Door chart with initial suggested settings for welding with flux cored wire and a CC power source with DC output
- Voltage-sensing lead with clip, 13 ft (4 m)
- 115 V power cord with plug, 5 ft (1.5 m)

*Note: Shielding gas and safety equipment not included.*

**Small size and light weight** make this unit more portable than many other wire feeders or small all-in-one MIG units.

**M-25, 10 ft welding gun** supplied as standard with the 3045 FC Feeder.

**TRUE BLUE**  
3YR. WARRANTY

The feeder is warranted for 3 years, parts and labor.  
The gun is warranted for 90 days, parts and labor.

MADE IN **USA**



**Miller Electric Mfg. Co.**  
An Illinois Tool Works Company  
1635 West Spencer Street  
Appleton, WI 54914 USA

**International Headquarters**  
Phone: 920-735-4505  
USA FAX: 920-735-4134  
Canadian FAX: 920-735-4169  
International FAX: 920-735-4125

**Web Site**  
[www.MillerWelds.com](http://www.MillerWelds.com)



# Specifications (Subject to change without notice.)



(Use with CC/CV, DC Power Sources.)

Type of Control Input Power	Type of Weld Input Power	Wire Feed Speed Range**	Wire Type and Diameter	Input Welding Circuit Rating	Wire Spool Capacity	Dimensions	Weight
115 VAC 2 A	Open-circuit/ arc voltage, 15–100 volts DC	CC: 30–350 IPM (.8–8.9 MPM) CV: 30–600 IPM (.8–15.3 MPM)	Flux Cored: .030–.045 in (0.8–1.2 mm) Solid Steel*: .024–.035 in (0.6–0.9 mm) Stainless Steel*: .030–.035 in (0.8–0.9 mm)	175 A at 60% Duty Cycle  Maximum: 225 A at 30% Duty Cycle	2 lb (0.9 kg), 4 in (102 mm)  10 lb (4.5 kg), 8 in (203 mm)	H: 11-5/8 in (295 mm) L: 18 in (457 mm) W: 8-5/8 in (219 mm)	Net: <b>Wire Feeder:</b> 29 lb (13.2 kg) <b>Gun:</b> 5.4 lb (2.6 kg)  Ship: 37 lb (16.8 kg)

\*Requires optional gas solenoid kit and a CV power source. \*\*Actual range is dependent on arc voltage applied.

Certified by Canadian Standards Association to both Canadian and U.S. Standards.

## Control Panel

1. Gun Connection
2. Power Switch
3. Wire Speed Control
4. Connection for Gun Trigger Lead
5. Voltage Sensing Lead

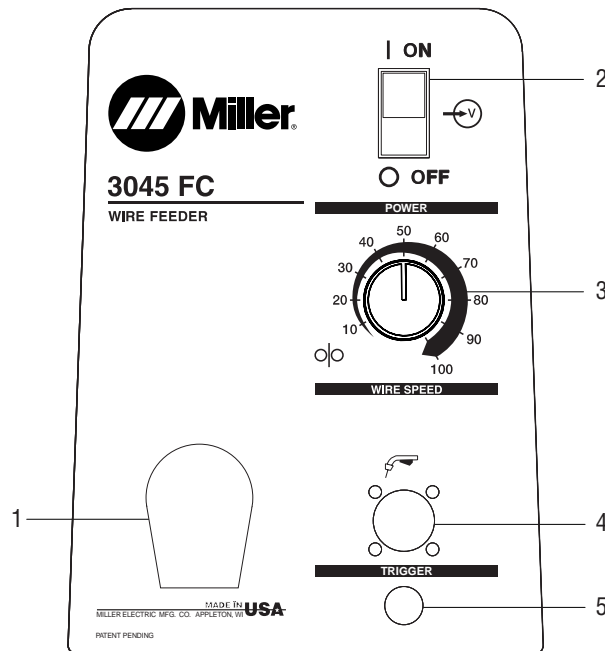

1. Fuse, Control Power
2. Calibrated Tension Knob
3. Spool Hub/Retaining Ring
4. CC/CV Selection Switch
5. T-Knob (secures torch)
6. Dual Groove Quick-Change Drive Roll
7. Optional Gas Solenoid Valve
8. Rubber Boot (protects weld cable connection)
9. 115 V Input Cord

Left Side View

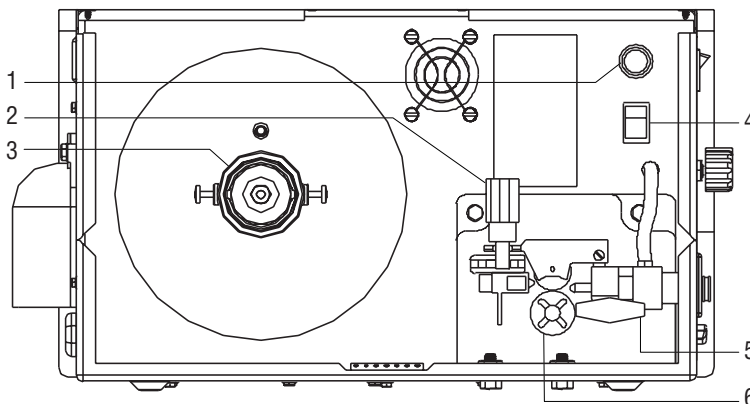

Rear View

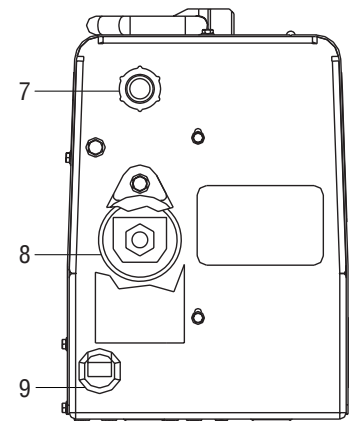

## Genuine Miller Options

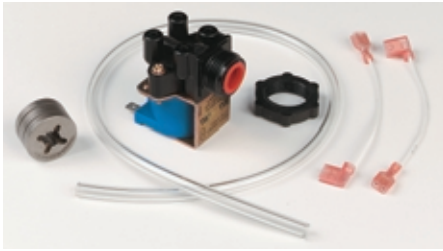

**Gas Solenoid Valve Kit #194 982**  
Includes gas valve, hose, wires, instructions, #169 728 tip adapter, #169 729 nozzle adapter, #169 730 shock washer, #200 258 nozzle and #202 925 feed roll.



### Drive Rolls—Quick Change

**#202 925** Dual Groove, V-Smooth  
For .023/.025 in and .030–.035 in  
(0.6 mm and 0.8–0.9 mm) wire

**#202 926** Dual Groove, V-Knurled  
For .030–.035 in and .045 in  
(0.8–0.9 mm and 1.2 mm) flux cored wire  
(standard with the 3045 FC feeder)

## Typical Installation

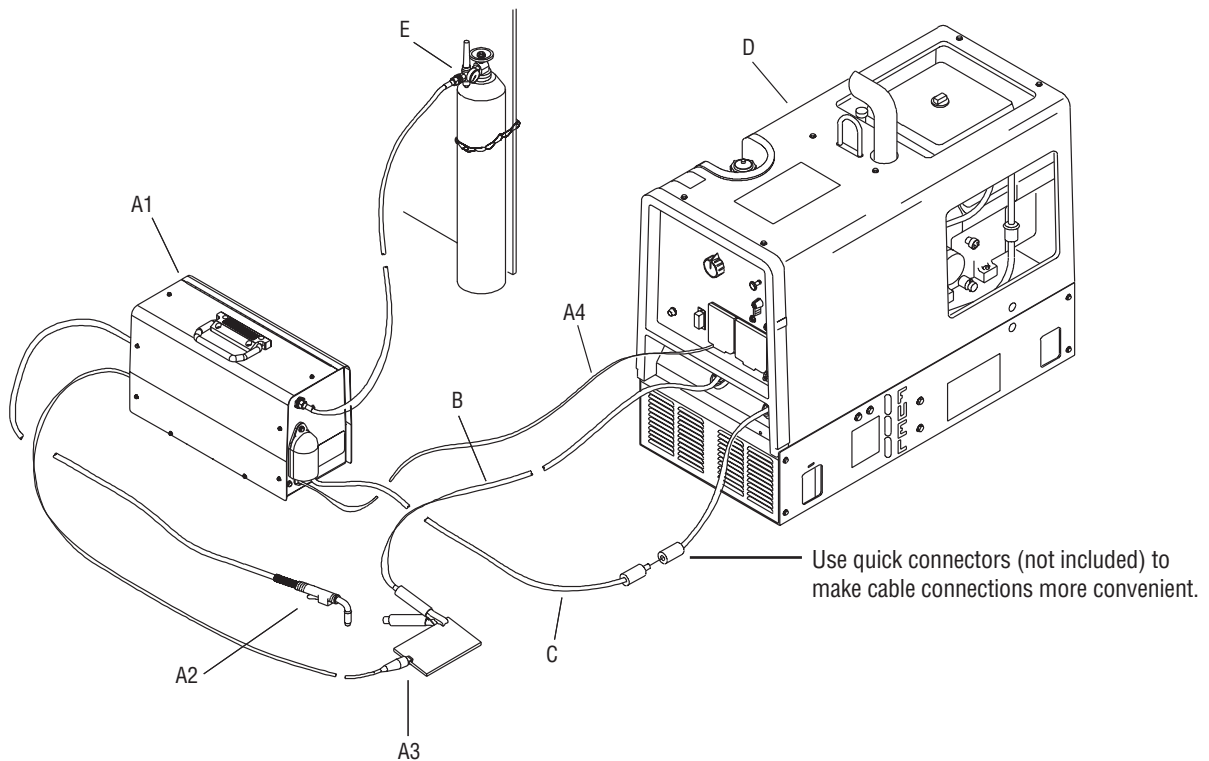

- A1.** 3045 FC wirefeeder with feedroll set for correct wire/diameter and CC/CV switch set to match power source.
- A2.** 10 ft MIG gun with properly sized liner and tip (10 ft is maximum recommended length).
- A3.** Voltage-sensing lead with clip—attach to work piece.
- A4.** 115 V input cord—connect to wall outlet or auxiliary power (use properly sized extension cords).
- B.** Properly sized work cable and clamp attached to proper output stud for polarity required by the wire.
- C.** Properly sized weld cable. Attached to the power source for the proper polarity and to the back of the feeder (the 3045 FC is supplied with 1/2 in bolt and 3/4 in nut).
- D.** The Power Source can be an engine driven unit or electric.
  - DC Constant Current (CC)**—can be used for flux cored wire without gas.  
Add the solenoid kit for flux cored wire requiring gas.
  - DC Constant Voltage (CV)**—can be used for flux cored wire without gas.  
Add the solenoid kit to use mild steel, stainless or flux cored wire with the proper shielding gas.  
Add properly sized extension cables for the lengths required.
- E.** Add gas solenoid kit to the 3045 FC plus gas hose, regulator, and gas source if required.

# Ordering Information

Equipment and Options	Stock No.	Description	Qty.	Price
<b>3045 FC</b>	<b>#194 919</b>	Wire feeder with 10 ft (3 m), 250 A gun		
Gas Solenoid Valve Kit	<b>#194 982</b>	For the 3045 FC feeder		
Drive Rolls — Quick Change	<b>#202 925</b> <b>#202 926</b>	Dual groove, V-smooth, for .023/.025 in and .030–.035 in (0.6 mm and 0.8–0.9 mm) solid or flux cored wire Dual groove, V-knurled, for .030–.035 in and .045 in (0.8–0.9 mm and 1.2 mm) flux cored wire (standard with 3045 FC)		
<b>Consumables</b>		See Lit. Index No. AY/15.0 for more gun info		
Liners	<b>#194 010</b> <b>#194 011</b> <b>#194 012</b>	For .023/.025 in (0.6 mm) wire For .030–.035 in (0.8–0.9 mm) wire (standard with M-25 gun) For .035–.045 in (0.9–1.2 mm) wire		
Contact Tips	<b>#087 299</b> <b>#000 067</b> <b>#000 068</b> <b>#000 069</b>	For .023/.025 in (0.6 mm) wire For .030 in (0.8 mm) wire (2 supplied with 3045 FC) For .035 in (0.9 mm) wire (2 supplied with 3045 FC) For .045 in (1.2 mm) wire		
Contact Tip Adapter	<b>#169 728</b>	For M-25 gun (standard with M-25)		
Nozzle Adapter	<b>#169 729</b>	For M-25 gun (standard with M-25)		
Nozzle	<b>#200 258</b>	For M-25 gun (standard with M-25)		
Gun Convenience Kit	<b>#193 975</b>	See Lit. Index No. AY/15.0		
<b>Power Sources</b>				
Bobcat 250 NT		See Lit. Index No. ED/4.4		
Bobcat 225 NT		See Lit. Index No. ED/4.31		
Blue Star 6000		See Lit. Index No. ED/2.6		
Other Machines with DC Output		Most CC or CV power sources, with DC output when used within the rating of the 3045 FC wire feeder		
<b>Accessories</b>				
Weld Cable with Lugs		Feeder accepts 1/2 in lug, size cable for length		
Work Lead with Clamp		From power source to work, size cable for length		
115 V Power Supply		For the 3045 FC from a wall outlet or auxiliary power		
115 V Extension Cord		The 3045 FC comes standard with 5 ft cord and plug		
Flux Cored Wire				
Solid Wire				
Shielding Gas Source				
Regulator/Flowmeter				
Gas Hose with Fittings				
Helmet/Gloves/Brush				

Date:

Total Quoted Price:



Distributed by: