

AUTO-DARKENING WELDING HELMETS



Serious Protection With Attitude!

It's hard to take your eyes off the new auto-darkening helmets from Miller. Their vibrantly colored wrap-around designs bring the graphics quality of top-of-the-line motorcycle and racing helmets to the welding world.

But the beauty is more than skin deep. High-end auto-darkening features like variable shade adjustment, ultra-clear light-state viewing and optional delay/lens sensitivity controls mean you won't have to take your eyes—or hands—off your work. That translates into a lot less head bobbing, for a lot more productivity and comfort.

Best of all, Miller auto-darkening helmets cost up to \$100.00 less than helmets with similar features.

The only hard part of this buying decision is choosing your favorite design!

All helmets feature:

- Auto-on/auto-off circuitry with reset function
- Self-recharging Solarcell™ lithium battery
- Continuous eye protection against UV and IR radiation, even when lens is in #3.5 ultra-clear (light-state) mode
- Lightweight polyamide nylon materials for excellent durability
- Fully adjustable ratchet-style head gear with advanced fabric “COSMEL” odor-absorbing headbands
- 18-month warranty

See your local Miller distributor for ordering information.

XL SERIES

- 1/16,000 sec. lens reaction time
- Variable welding shades (#9–#13) adjusted by *external* control knob

Viewing Field	98 mm x 47 mm (3.85 x 1.85 in.)
Dark to Clear Delay	Automatic Fixed
Number of Sensors	2
Operating Temperature	-10° C – +55° C (14° F – 131° F)
Weight	16 oz. (453.6 g)

Standards – ANSI 287.1/DIN/CE/TÜV



XLI SERIES

- 1/16,000 sec. lens reaction time
- Variable welding shades (#9–#13) adjusted by *internal* control knob
- Lens sensitivity and delay controls are also adjusted inside helmet

Viewing Field	98 mm x 47 mm (3.85 x 1.85 in.)
Dark to Clear Delay	0.08 – 0.05 sec.
Number of Sensors	2
Operating Temperature	-10° C – +55° C (14° F – 131° F)
Weight	16 oz. (453.6 g)

Standards – ANSI 287.1/DIN/CE/TÜV



XLix SERIES

- 1/20,000 sec. lens reaction time
- Variable welding shades (#9–#13) adjusted by *external* control knob
- Lens sensitivity and delay controls are also adjusted inside helmet
- Magnifier lens holding system

Viewing Field	98 mm x 47 mm (3.85 x 1.85 in.)
Dark to Clear Delay	0.08 – 0.05 sec.
Number of Sensors	2
Operating Temperature	-10° C – +55° C (14° F – 131° F)
Weight	16 oz. (453.6 g)

Standards – ANSI 287.1/DIN/CE/TÜV



American Eagle*

#770 227 \$199.00



Asteroid*

#770 097 \$199.00



Flame*

#770 098 \$199.00



Black (XL)*

#770 186 \$179.00



Millermatic®

Miller #205 999 \$199.00

LIMITED EDITION



Dale Earnhardt Sr.*

#770 252 \$249.00

Available May 2002



Dale Earnhardt Jr.*

#770 228 \$249.00

Available April 2002

Dale Earnhardt Jr. helmet features the same stunning "skull" and "flaming eight ball" designs as Dale Earnhardt Jr.'s racing helmet

RACER SERIES

Includes optional Hobart helmet bag. #770 251



Stars and Stripes

Miller #208 452 \$229.00

Available April 2002



Black (XLix)

Miller #208 451 \$209.00

Available April 2002



Helmet Bag with Miller Logo

Features drawstring closure, ultra-soft inside liner and convenient exterior storage pouch for gloves, glasses, etc. #770 250 \$9.95

AUTO-DARKENING HELMET REPLACEMENT PARTS

Item #	Description	XL Series Stock #	XLi Series Stock #	XLix Series Stock #
1	Helmet shell, American Eagle (XL)	770 229		
1	Helmet shell, Asteroid (XL)	770 230		
1	Helmet shell, Black (XL)	770 231		
1	Helmet shell, Flame (XL)	770 232		
1	Helmet shell, Millermatic® (XLi)		770 233	
1	Helmet shell, Dale Earnhardt Sr. (XLi)		770 253	
1	Helmet shell, Dale Earnhardt Jr. (XLi)		770 234	
1	Helmet shell, Stars and Stripes (XLix)			770 235
1	Helmet shell, Black (XLix)			770 236
2	Inside lens cover, all (small 4-1/2 x 2 in)	770 237	770 237	770 237
3	Auto-darkening lens assembly	770 121 (w/hardware)	770 238 (lens only)	770 239 (w/hardware)
4	Front lens cover (large 4-1/2 x 3-3/8 in)	770 240	770 240	
4	Front lens cover, XLix (large 4-5/8 x 3-3/4 in)			770 241
5*	Front lens holder kit, Black	770 156	770 156	
5*	Front lens holder kit, Gray		770 242	
5*	Front lens holder kit, Red		770 243	
5*	Front lens holder kit, Blue			770 244
5*	Front lens holder kit, Black (XLix)			770 245
6	Ratchet headgear assembly	770 120	770 120	770 246
7	Adjustment angle/stop hardware kit	770 247	770 247	770 248
8	"Cosmel" fabric headband	770 249	770 249	770 249
9	Helmet bag with drawstring and pouch (Miller logo)	770 250	770 250	770 250
10	Helmet bag with drawstring (Hobart logo)	770 251	770 251	770 251

*Kit includes: Front lens holder, 5 large lens covers, 1 small lens cover

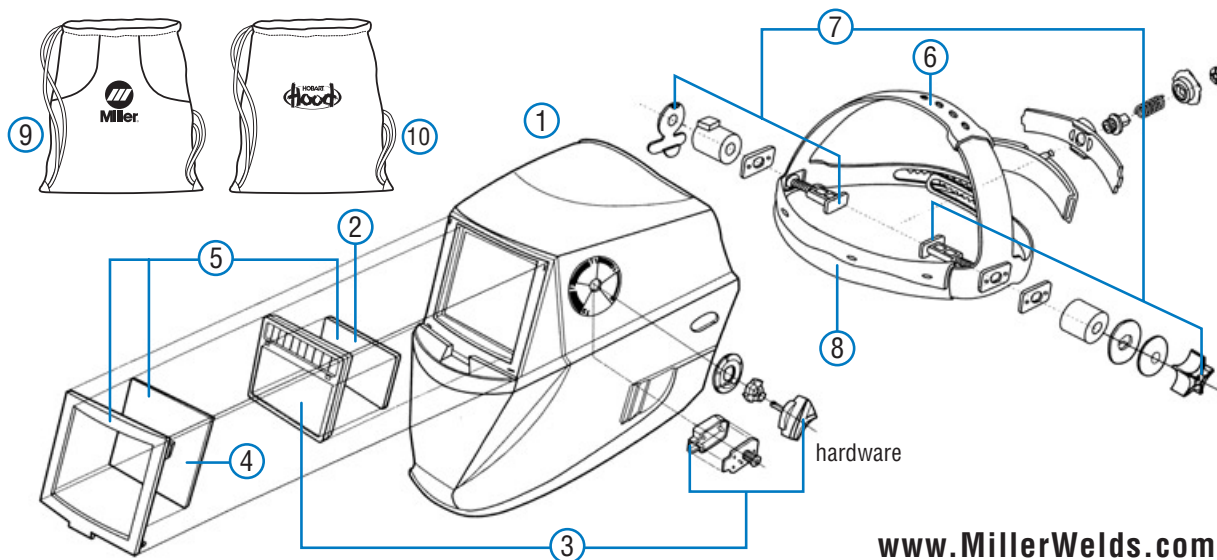

www.MillerWelds.com



An Illinois Tool Works Company
©2002 Miller Electric Mfg. Co.

Distributed by: